

Versatile™ 4C Mailbox, 4C15S-06

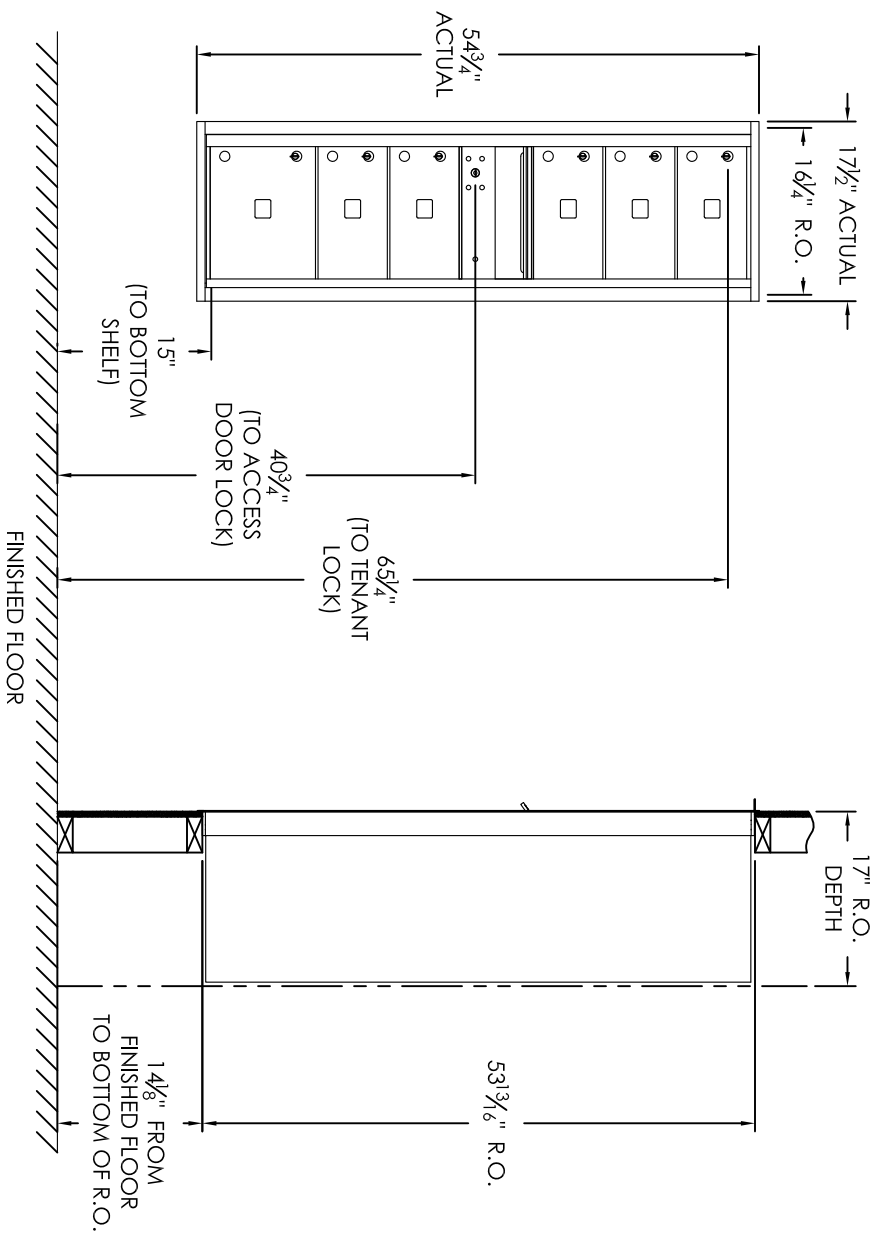

COMPARTMENT CHART

DESCRIPTION	COMPARTMENT	COMPARTMENT SIZE	QTY.
MAILBOX	MB2	6-1/2" H x 12" W x 15" D	5
MAILBOX	MB3	10" H x 12" W x 15" D	1
OUTGOING MAIL	OM2	6-1/2" H x 12" W x 15" D	1

PRODUCT SERIES: VERSATILE™ 4C FRONT LOAD MAILBOX

MODEL 4C15S-06

REV D

SCALE NONE LAST REV DATE 5/15/14

DRAWING NUMBER 4C15S-06CS DRAWN BY RS

AF FLORENCE
manufacturing company

5935 Corporate Drive • Manhattan, KS 66503
 www.florencemailboxes.com • (800) 275-1747
 A GIBRALTAR INDUSTRIES COMPANY

Notes:

- This module does NOT meet USPS STD-4C installation specification requirements as shown below:
 - At least one customer compartment shall be positioned less than 48" above finished floor (AFF).
 - No parcel locker (interior bottom shelf) shall be positioned less than 15" AFF.
 - No patron (tenant) lock shall be positioned more than 67" AFF.
 - No customer compartment (interior bottom shelf) shall be positioned less than 28" AFF.
 - The USPS Arrow lock shall be positioned 36" - 48" AFF.
- This 4C mailbox is to be used for private applications.
- The rough opening width for multi-unit 4C installations = (the sum of all actual unit widths) - 1/8".